

# Straight Router Bits with Insert Knives



## 653

Straight router bits with a replaceable plunging knife and side knife fixed by a special TORX® screw. The tool bodies are precisely balanced. For finishing, routing, plunging and grooving on board materials (laminated chipboards and MDF) and hardwood. For use on portable routers or CNC machining centres.

**SAFETY TIPS:**



The **TW-006** Torque Screwdriver is recommended for the proper fastening of screws (see page 406).

**CORRECT KNIFE POSITIONING**

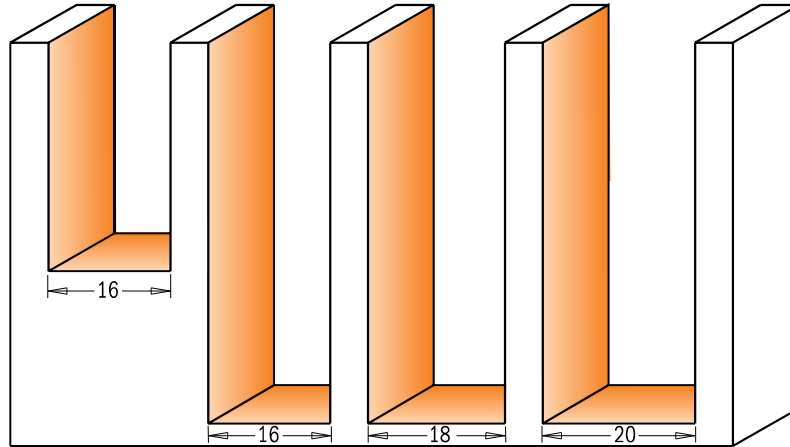
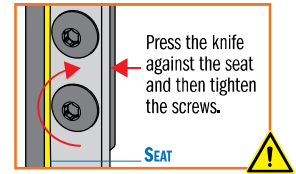

Drawing is 1:1 scale

D mm	I mm	L mm		ORDER NO. S=Ø8mm	ORDER NO. S=Ø12mm	ORDER NO. S=Ø12,7mm	ORDER NO. S=Ø20mm	Spare parts					
15,8	28,3	92	10			<b>653.158.11</b>							
16	28,3	82	10	<b>653.160.11</b>				790.283.12	990.074.00	990.075.00	790.075.00	990.072.00	991.061.00
16	28,3	92	10		<b>653.161.11</b>		<b>653.661.11</b>	790.283.12	990.074.00	990.075.00	790.075.00	990.072.00	991.061.00
16	48,3	111,5	10		<b>653.162.11</b>		<b>653.662.11</b>	790.483.12	990.074.00	990.075.00	790.075.00	990.072.00	991.061.00
18	48,3	111,5	10				<b>653.681.11</b>	790.483.12	990.074.00	990.075.00	790.075.00	990.072.00	991.061.00
20	48,3	111,5	10				<b>653.701.11</b>	790.483.12	990.074.00	990.075.00	790.096.00	990.072.00	991.061.00

# Straight Router Bits with Insert Knives

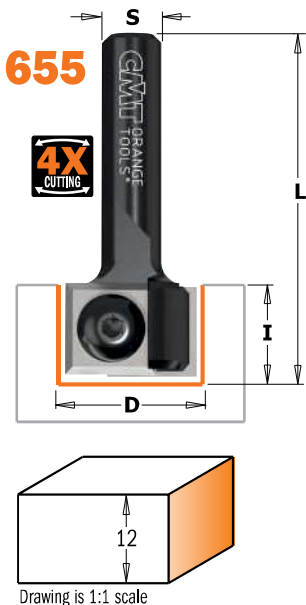

## 654



For finishing, routing, plunging and grooving on board materials (laminated chipboards and MDF) and hardwood. For use on portable routers, **point to point**, or CNC centres.

**SAFETY TIPS:**



The **TW-006** Torque Screwdriver is recommended for the proper fastening of screws (see page 406).

**CORRECT KNIFE POSITIONING**

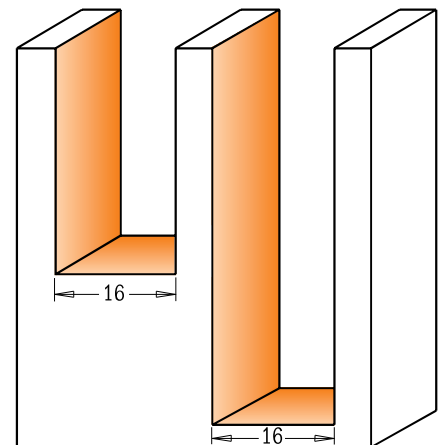
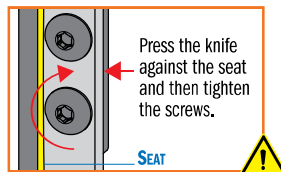

Drawing is 1:1 scale

D mm	I mm	L mm		ORDER NO. S=Ø8mm	ORDER NO. S=Ø12mm	ORDER NO. S=Ø12,7mm	ORDER NO. S=Ø20mm	Spare parts		
16	28,3	76	10	<b>654.160.11</b>						
16	28,3	87	10		<b>654.161.11</b>	<b>654.661.11</b>		790.283.12	990.073.00	991.061.00
16	48,3	105	10		<b>654.162.11</b>		<b>654.662.11</b>	790.283.12	990.073.00	991.061.00
19	12	45	10	<b>655.190.11</b>				790.483.12	990.073.00	991.061.00
								790.120.00	990.075.00	991.061.00